

MAINTENANCE FREE MEDIUM HEAVY DUTY CASTERS

CAPACITY RANGE 350-2000 LBS



Ergonomic



Maintenance Free

Common Applications:

- Production Racks and Carts
- Conveyor Systems
- Part Carts
- Tool Dollies
- Floor Trucks
- Warehouse Trucks
- Distribution Cages and Carts

68 Series

Ergonomic Maintenance Free Caster
with AX Wheel



18 Series Maintenance Free
Capacity to 1250 **36-37**

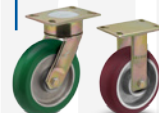

68 Series Maintenance Free
Capacity to 2000 **38-39**

Maintenance Free Advantage

- Ergonomically designed
- Easier push/pull force
- Quieter operation
- Reduced maintenance costs
- Long life in towing application (68 Series)

Maintenance Free Rig + AX Wheel = Preferred Ergonomic Solution

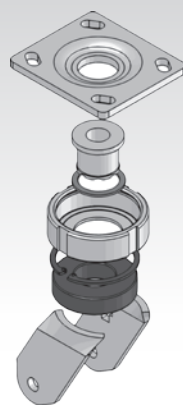

**SEALED PRECISION SWIVEL BEARING
PROVIDES EXCELLENT ERGONOMICS
WITH NO MAINTENANCE**
• UP TO 2,000 LBS. CAPACITY

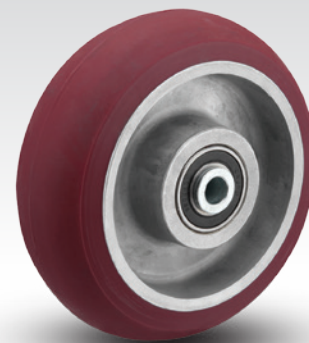

- **EASIEST MOVEMENT**
- **REDUCES NOISE**
- **DEBRIS RESISTANT**
- **FLOOR PROTECTIVE**

MAINTENANCE FREE MEDIUM HEAVY DUTY