

RHOMBUS



367 & 364

APPLICATIONS

- Care beds
- Medical-technical equipment
- Physical therapy equipment
- Rehab apparatus

FEATURES

- Stamped and drawn horn assembly
- Zinc-plated
- Double ball raceway that's sealed

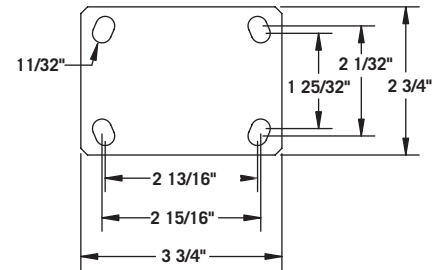

367 SERIES PF

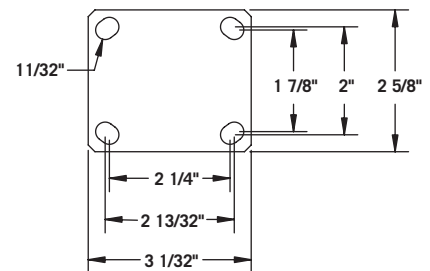
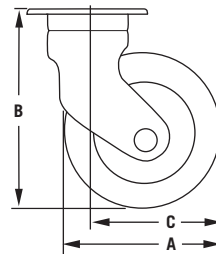

367 SERIES PD

▼ DIMENSIONS

367/364 Series with Top Plate

A: Wheel Diameter	3" (80mm)	4" (100mm)	5" (125mm)	6" (150mm)
B: Overall Height	4 1/2" (117mm)	5 1/4" (137mm)	6 1/2" (163mm)	7 1/2" (189mm)
C: Swivel Radius	3 1/4" (84mm)	3 1/2" (92mm)	3 1/4" (85mm)	4" (100mm)
C: Swivel Radius w/ brake	4" (100mm)	4 1/4" (106mm)	4 1/2" (110mm)	4 1/2" (110mm)

▼ MOUNTING OPTIONS



Hollow Kingpin
LD: 12mm, LU: 1/2"



Expansion Stem*

